

# **VP** Series



MOD Series  
M Series  
MC Series  
MCS Series  
VP Series  
100 Series  
S Series

- Operating voltages up to 13 kVDC
- Operating current 13 Amps / 30 Amps
- Ideal for internal cabling
- Quick assembly
- Several mounting options offering enhanced flexibility

# General characteristics and technical data Series VarioPro CL

Electrical values	
Operating voltage (DC)	13 kV
Test voltage (DC)	20 kV

Housing	
Number of HV contacts	1 - 3
Insulation material	PBT
Flammability class	UL94 V-0
Operating temperature	-40 °C to +150 °C
Insulating material group	I (DIN IEC 60664)

Contacts 1.6 mm	
Termination method	crimp
Rated current	13 A
Contact resistance	≤ 5 mΩ
Contact diameter	1.6 mm [.063"]
Wire size (AWG / cross section)	AWG 26 - 14 (0.14 - 2.5 mm <sup>2</sup> )
Contact material	brass (CuZn)
Contact plating	silver (Ag), gold (Au)
Mating cycles	≥ 1,000
Rated temperature	+120 °C

## Suitable cable dimensions

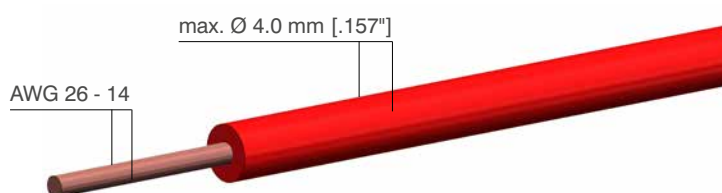

## VarioPro CL1 - receptacle

Drawing

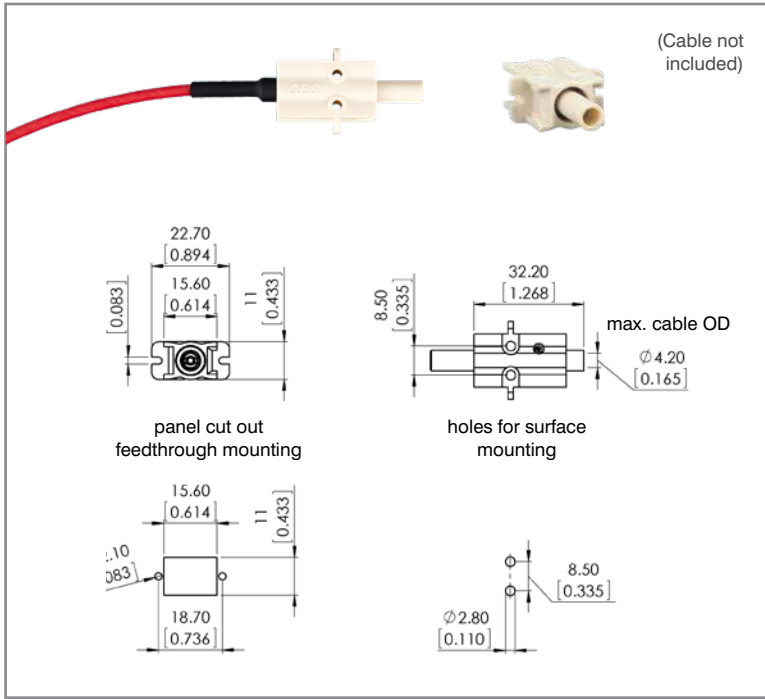

## VarioPro CL1 - plug

Drawing

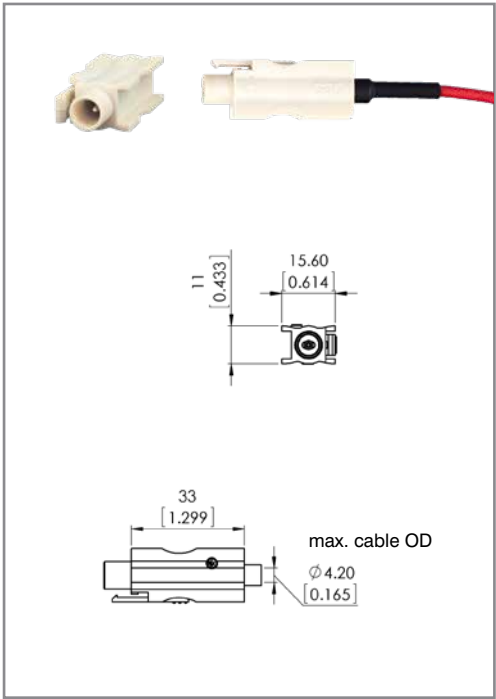

drawing - dimensions in mm [inch]

P/N	Description	Plug male contact	Receptacle female contact	Number of contacts	Including contacts	Contacts silver plated	Contacts gold plated
5000440	VP-CL-1HV-BU AWG 26 - 22 Ag		•	1	•	•	
5000441	VP-CL-1HV-BU AWG 20 Ag		•	1	•	•	
5000442	VP-CL-1HV-BU AWG 20 - 16 Ag		•	1	•	•	
5000443	VP-CL-1HV-BU AWG 16 - 15 Ag		•	1	•	•	
5000444	VP-CL-1HV-BU AWG 14 Ag		•	1	•	•	
5000445	VP-CL-1HV-BU AWG 26 - 22 Au		•	1	•		•
5000446	VP-CL-1HV-BU AWG 20 Au		•	1	•		•
5000447	VP-CL-1HV-BU AWG 20 - 16 Au		•	1	•		•
5000448	VP-CL-1HV-BU AWG 16 - 15 Au		•	1	•		•
5000449	VP-CL-1HV-BU AWG 14 Au		•	1	•		•
5000450	VP-CL-1HV-ST AWG 26 - 22 Ag	•		1	•	•	
5000451	VP-CL-1HV-ST AWG 20 Ag	•		1	•	•	
5000452	VP-CL-1HV-ST AWG 20 - 16 Ag	•		1	•	•	
5000453	VP-CL-1HV-ST AWG 16 - 15 Ag	•		1	•	•	
5000454	VP-CL-1HV-ST AWG 14 Ag	•		1	•	•	
5000455	VP-CL-1HV-ST AWG 26 - 22 Au	•		1	•		•
5000456	VP-CL-1HV-ST AWG 20 Au	•		1	•		•
5000457	VP-CL-1HV-ST AWG 20 - 16 Au	•		1	•		•
5000458	VP-CL-1HV-ST AWG 16 - 15 Au	•		1	•		•
5000459	VP-CL-1HV-ST AWG 14 Au	•		1	•		•

➔ For cables and tools - please see page 69

# Type VarioPro CL

## 2-pole 13 kVDC

### VarioPro CL2 - receptacle

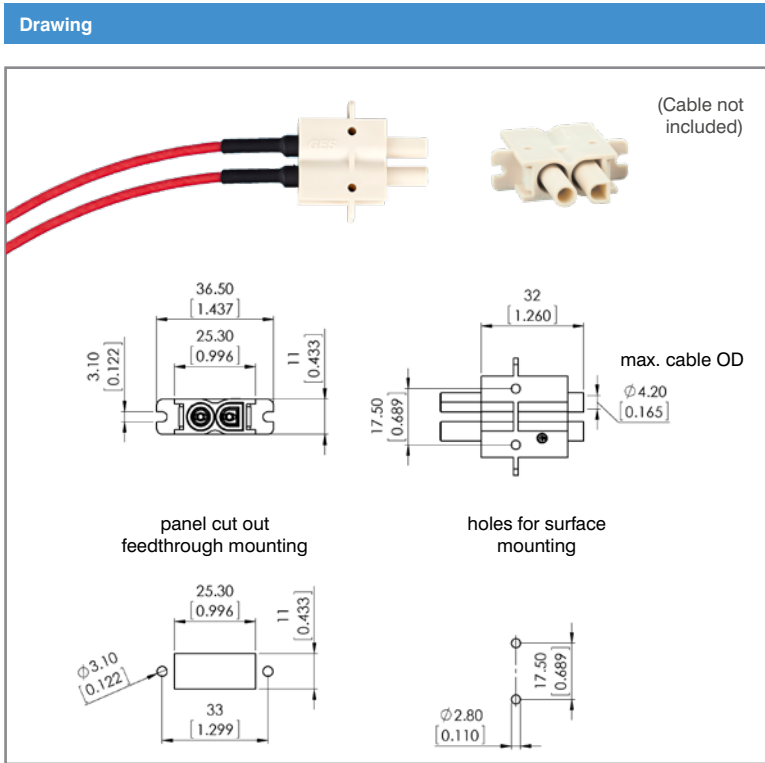

### VarioPro CL2 - plug

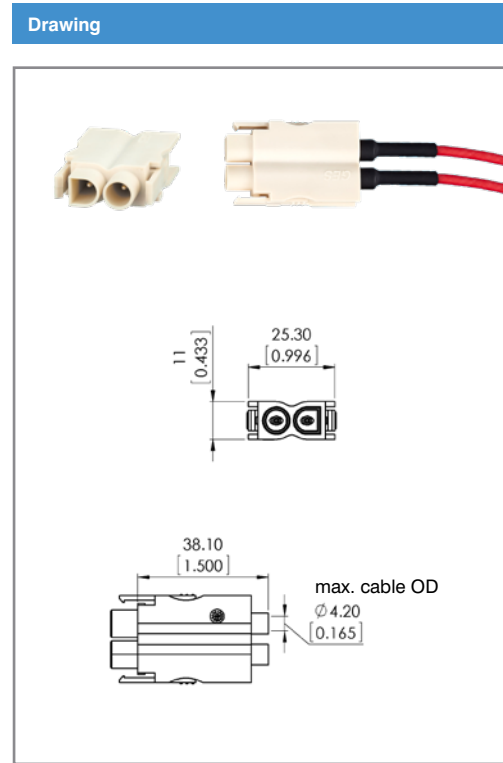

drawing - dimensions in mm [inch]

P/N	Description	Plug male contact	Receptacle female contact	Number of contacts	Including contacts	Contacts silver plated	Contacts gold plated
5000460	VP-CL-2HV-BU AWG 26 - 22 Ag		•	2	•	•	
5000461	VP-CL-2HV-BU AWG 20 Ag		•	2	•	•	
5000462	VP-CL-2HV-BU AWG 20 - 16 Ag		•	2	•	•	
5000463	VP-CL-2HV-BU AWG 16 - 15 Ag		•	2	•	•	
5000464	VP-CL-2HV-BU AWG 14 Ag		•	2	•	•	
5000465	VP-CL-2HV-BU AWG 26 - 22 Au		•	2	•		•
5000466	VP-CL-2HV-BU AWG 20 Au		•	2	•		•
5000467	VP-CL-2HV-BU AWG 20 - 16 Au		•	2	•		•
5000468	VP-CL-2HV-BU AWG 16 - 15 Au		•	2	•		•
5000469	VP-CL-2HV-BU AWG 14 Au		•	2	•		•
5000470	VP-CL-2HV-ST AWG 26 - 22 Ag	•		2	•	•	
5000471	VP-CL-2HV-ST AWG 20 Ag	•		2	•	•	
5000472	VP-CL-2HV-ST AWG 20 - 16 Ag	•		2	•	•	
5000473	VP-CL-2HV-ST AWG 16 - 15 Ag	•		2	•	•	
5000474	VP-CL-2HV-ST AWG 14 Ag	•		2	•	•	
5000475	VP-CL-2HV-ST AWG 26 - 22 Au	•		2	•		•
5000476	VP-CL-2HV-ST AWG 20 Au	•		2	•		•
5000477	VP-CL-2HV-ST AWG 20 - 16 Au	•		2	•		•
5000478	VP-CL-2HV-ST AWG 16 - 15 Au	•		2	•		•
5000479	VP-CL-2HV-ST AWG 14 Au	•		2	•		•



For cables and tools - please see page 69

## VarioPro CL3 - receptacle

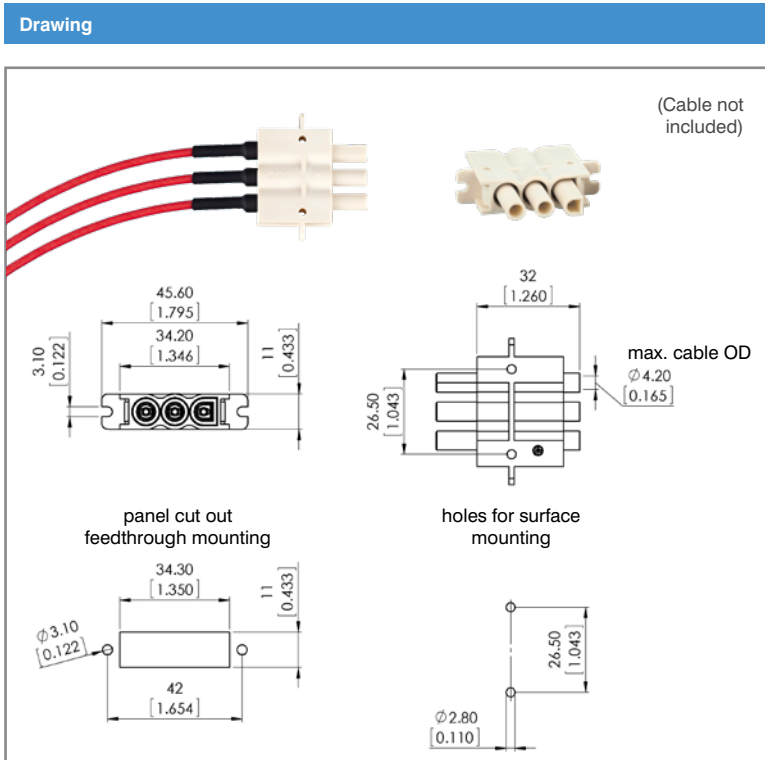

## VarioPro CL3 - plug

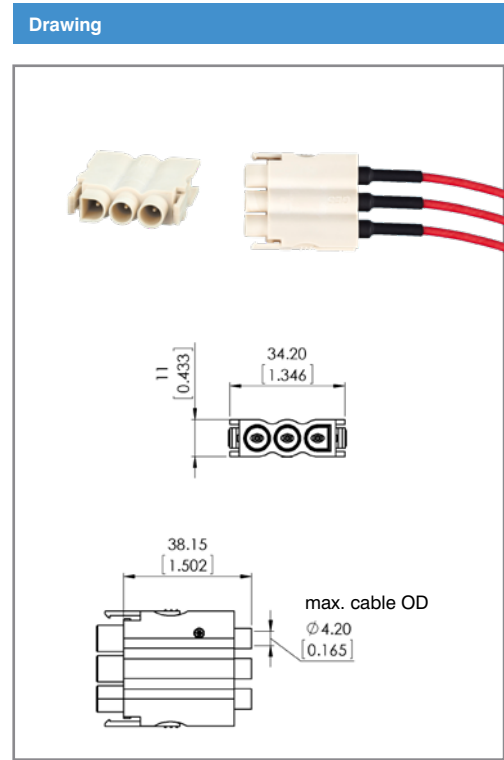

drawing - dimensions in mm [inch]

P/N	Description	Plug male contact	Receptacle female contact	Number of contacts	Including contacts	Contacts silver plated	Contacts gold plated
5000480	VP-CL-3HV-BU AWG 26 - 22 Ag		•	3	•	•	
5000481	VP-CL-3HV-BU AWG 20 Ag		•	3	•	•	
5000482	VP-CL-3HV-BU AWG 20 - 16 Ag		•	3	•	•	
5000483	VP-CL-3HV-BU AWG 16 - 15 Ag		•	3	•	•	
5000484	VP-CL-3HV-BU AWG 14 Ag		•	3	•	•	
5000485	VP-CL-3HV-BU AWG 26 - 22 Au		•	3	•		•
5000486	VP-CL-3HV-BU AWG 20 Au		•	3	•		•
5000487	VP-CL-3HV-BU AWG 20 - 16 Au		•	3	•		•
5000488	VP-CL-3HV-BU AWG 16 - 15 Au		•	3	•		•
5000489	VP-CL-3HV-BU AWG 14 Au		•	3	•		•
5000490	VP-CL-3HV-ST AWG 26 - 22 Ag	•		3	•	•	
5000491	VP-CL-3HV-ST AWG 20 Ag	•		3	•	•	
5000492	VP-CL-3HV-ST AWG 20 - 16 Ag	•		3	•	•	
5000493	VP-CL-3HV-ST AWG 16 - 15 Ag	•		3	•	•	
5000494	VP-CL-3HV-ST AWG 14 Ag	•		3	•	•	
5000495	VP-CL-3HV-ST AWG 26 - 22 Au	•		3	•		•
5000496	VP-CL-3HV-ST AWG 20 Au	•		3	•		•
5000497	VP-CL-3HV-ST AWG 20 - 16 Au	•		3	•		•
5000498	VP-CL-3HV-ST AWG 16 - 15 Au	•		3	•		•
5000499	VP-CL-3HV-ST AWG 14 Au	•		3	•		•

➔ For cables and tools - please see page 69

# Assembly Instructions Series VP ClipLock - plug



1.

**Part as supplied**  
Shrinking tube (1), male contact (2),  
connector shell (3)

5.



**Slide contact (2) completely into connector shell (3) until contact snaps**  
☞ Pull gently to check that contact is correctly located and remains in position

2.



Place shrinking tube (1) on cable

6.



Slide shrinking tube (1) on connector shell (3)

3.



Remove dielectric insulation (L1 = 5-8 mm)

7.



Shrink tube - shrinking temperature 110° C

4.



**Solder or crimp contact (2) on conductor**  
⚠ Please notice for soldering: Tin-solder must not remain on contact surface

8.



Assembly finished



**Note – important!**

1. Please carefully read assembly instructions before cable assembly.

2. Cable assembly must only be done by trained and qualified personnel.

1.



**Part as supplied**  
Shrinking tube (1), female contact (2),  
connector shell (3)

2.

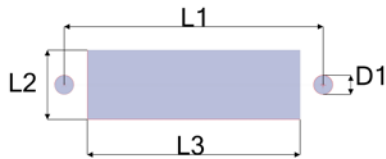

Panel cut out – feedthrough mounting

Type	D1 mm [inch]	L1 mm [inch]	L2 mm [inch]	L3 mm [inch]
VP-CL-1HV-BU	2.10 [.083"]	18.70 [.736"]	11.20 [.441"]	15.80 [.622"]
VP-CL-2HV-BU	3.10 [.122"]	33.00 [1.299"]	11.20 [.441"]	25.50 [1.004"]
VP-CL-3HV-BU	3.10 [.122"]	42.00 [1.654"]	11.20 [.441"]	34.50 [1.358"]

3.

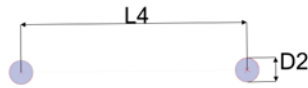

Panel cut out – surface mounting

Type	D2 mm [inch]	L4 mm [inch]
VP-CL-1HV-BU	2.80 [.110"]	8.50 [.335"]
VP-CL-2HV-BU	2.80 [.110"]	17.50 [.689"]
VP-CL-3HV-BU	2.80 [.110"]	26.50 [1.043"]

4.



Place shrinking tube (1) on cable

5.

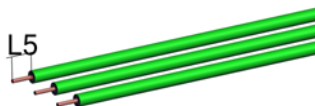

Remove dielectric insulation  
(L5 = 5-8 mm [.197" - .315"])

6.



**Solder or crimp contact (2) on conductor**  
⚠ Please notice for soldering: Tin-solder must not remain on contact surface

7.



**Slide contact (2) completely into connector shell (3) until contact snaps**  
🗨 Pull gently to check that contact is correctly located and remains in position

8.



Slide shrinking tube (1) on connector shell (3)

9.



Shrink tubes - shrinking temperature 110° C

10.



Assembly finished



**Note – important!**

1. Please carefully read assembly instructions before cable assembly.

2. Cable assembly must only be done by trained and qualified personnel.